



OUTLET RETRO-FIT OHMEDA DIAMOND 2 & 3 TO AMICO

SPECIFICATIONS:

The medical gas Retro-Fit outlet shall be an Amico **Alert-1** series.

Outlets shall be equipped with a primary and secondary check for positive pressure for gas services. The secondary check valve shall be rated at a minimum 200 psi [1,379 kPa] in the event the primary check valve is removed for maintenance. Outlet bodies shall be gas specific by indexing each gas service to a gas specific dual pin indexing arrangement on the respective identification module.

A large color coded front plate shall be used for ease of gas identification and aesthetic appeal.

A one piece filler plate shall cover the outlet. With the backbox rough-in mounted the outlet shall adjust from 3/8" [10 mm] to 1" [25 mm] variation in wall thickness.

The latch-valve assembly shall be Ohmeda Diamond™ (Ohio Medical) Quick Disconnect compatible and accept only corresponding Ohmeda type gas specific adapters, or any of the compatible outlets manufactured by Amico.

Amico products comply with NFPA-99.



FEATURES:

- Flow rate exceeds the requirements of NFPA and CSA.
- Accepts only Ohmeda Diamond™ gas specific adapters.
- 100 % hydrostatic testing of each outlet and cleaned for medical gas service.
- Indexed to eliminate interchangeability of gas services.
- Up to 1" [25 mm] wall thickness adjustment.
- Universal rough-in assembly to accept Quick Disconnects or DISS front adapters. (Can be interchanged at any time).

PROJECT:

D I M E N S I O N S

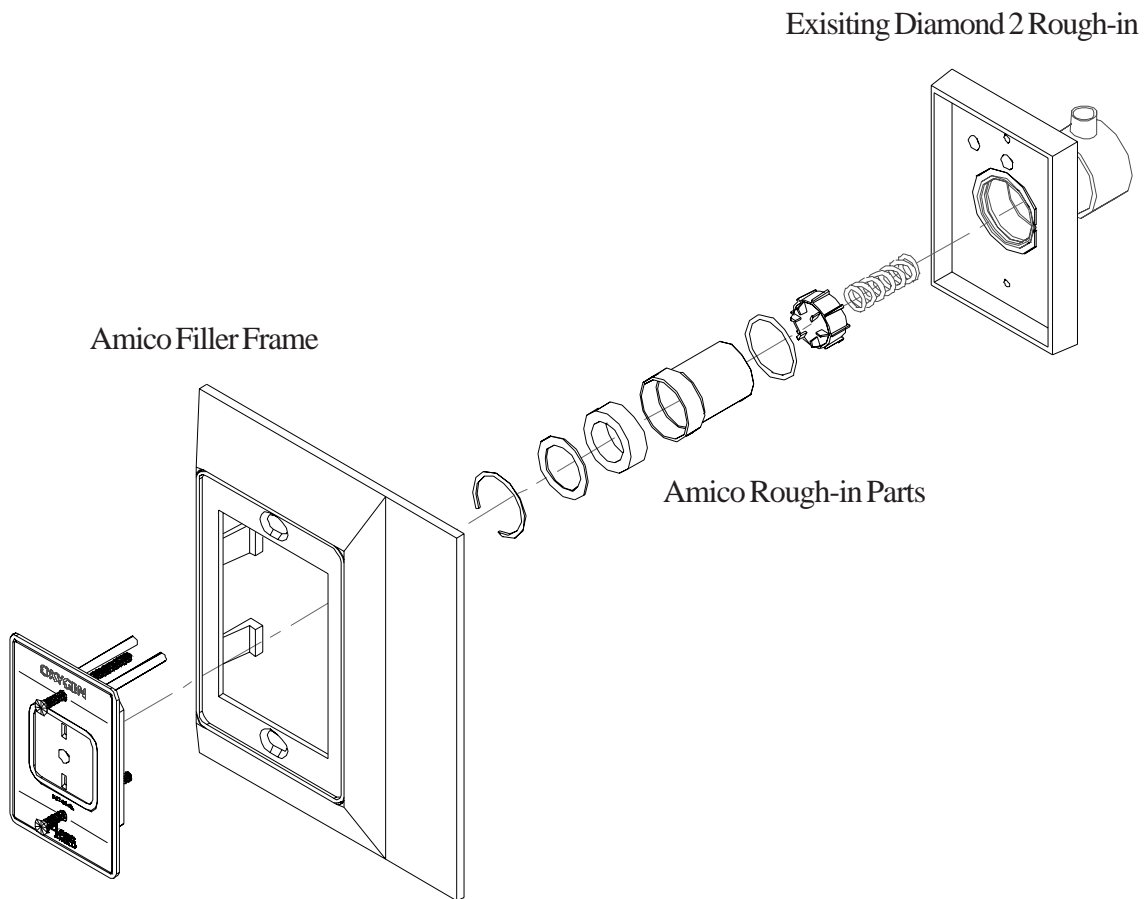

Amico Front Assembly
(Latch-valve)

M O D E L N U M B E R S

- | | | |
|-------------------------------|---|------------------------|
| Amico Rough-in Parts | = | O-VC-OH2-L-GAS |
| For example USA Oxygen | = | O-VC-OH2-U-OXY |
| Amico Filler Frame | = | O-CON-FIL-M450 |
| Amico Front Assembly | = | O-FC01-QD-L-GAS |
| For example USA Oxygen | = | O-FC01-QD-U-OXY |

D I S T R I B U T E D B Y :